

Käyttö- ja huolto-ohjeet **Operating and
maintenance** **Manual de uso y mantenimiento**
Gebrauchs- und Wartungsanweisung **Manual de
uso e manutenção** **Instructions d'utilisation et
d'entretien** **Bruksanvisning och service manual**
Bedienings- en onderhoudsvorschriften
**Инструкции по эксплуатации и техническому
обслуживанию**

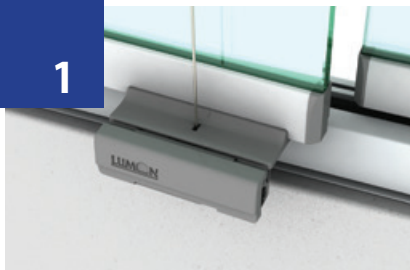

1



2



5



6

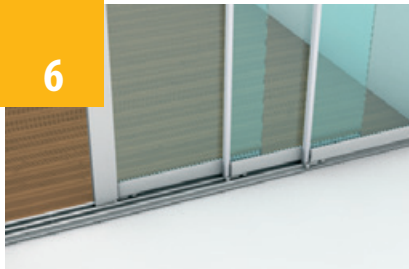

3



4

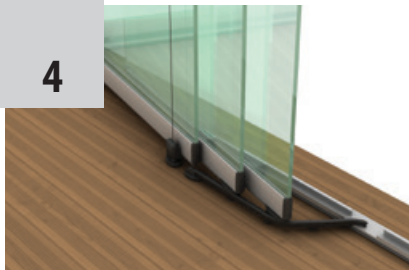

7



1

2

3

4

5

6

7



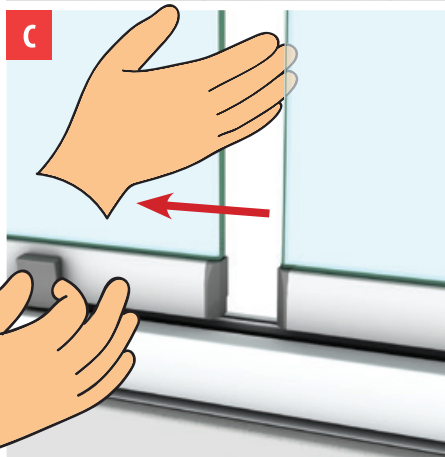
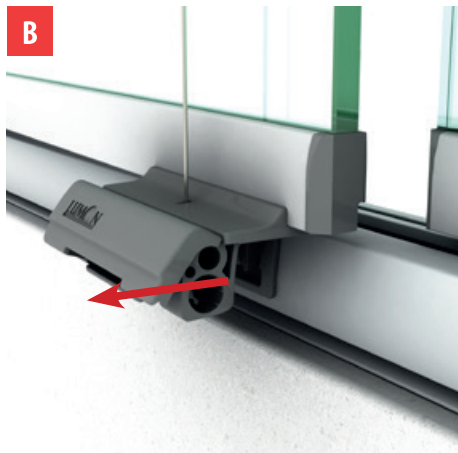

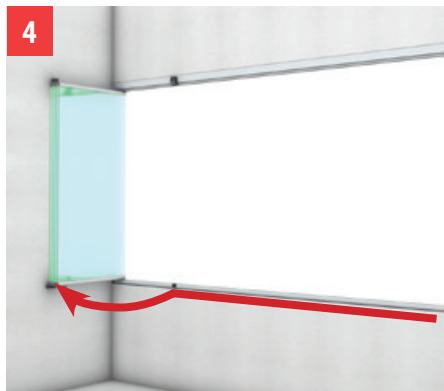
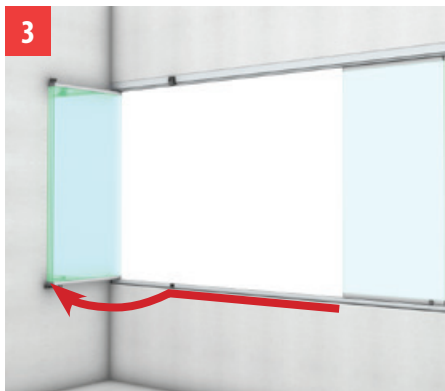
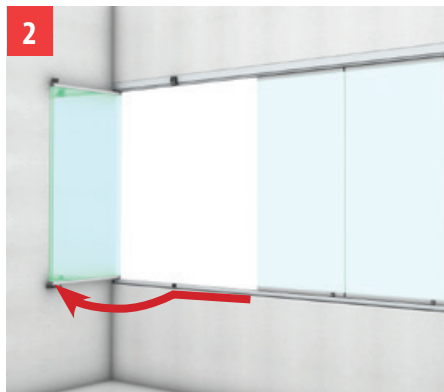

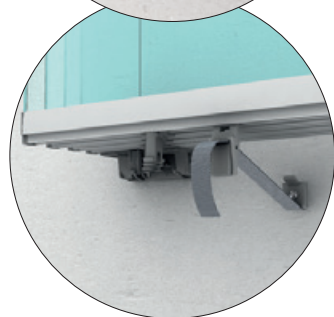
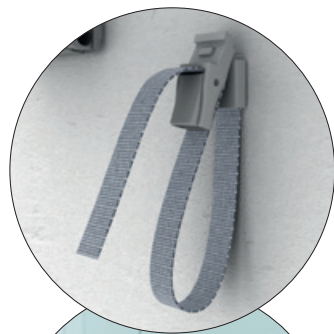
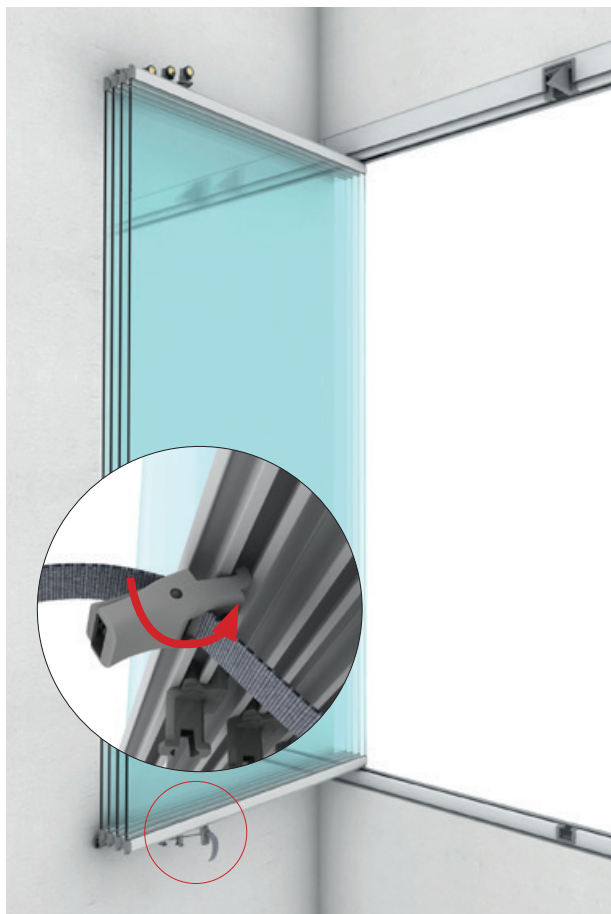

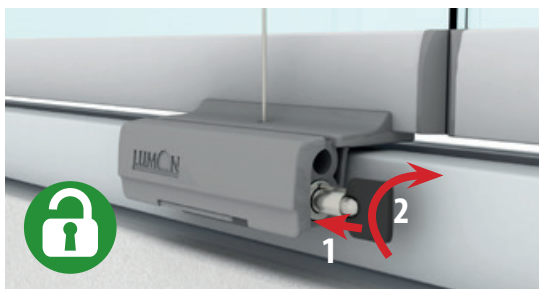
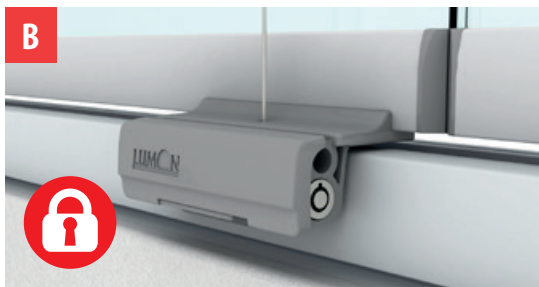
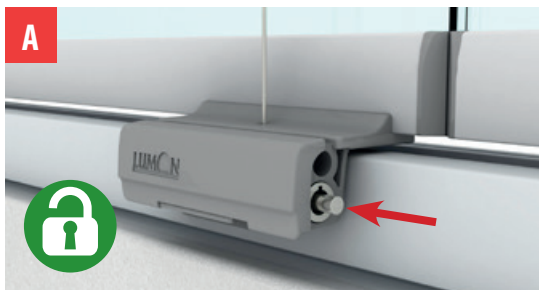





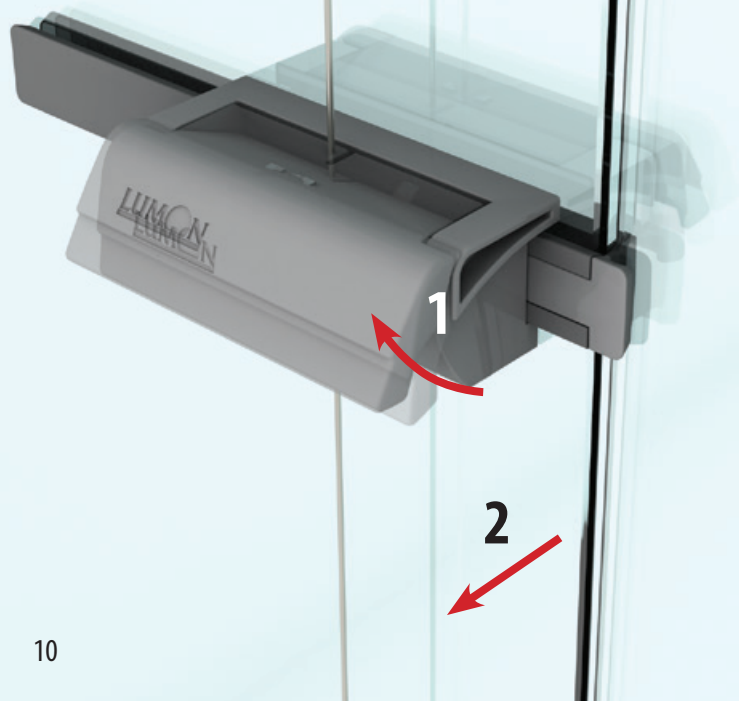

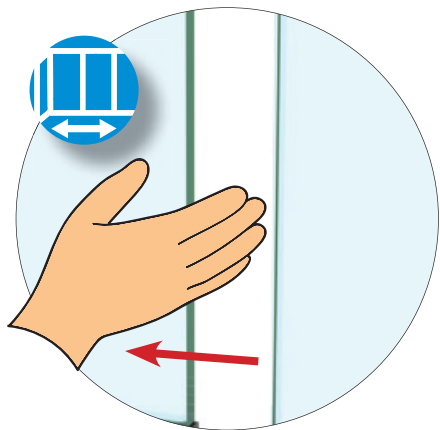

2

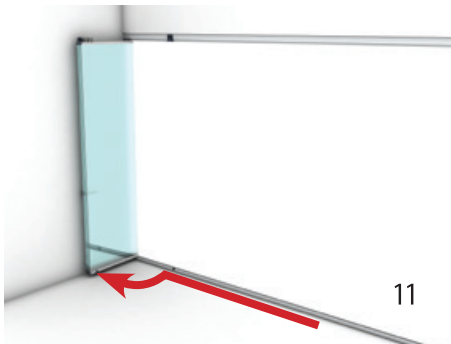
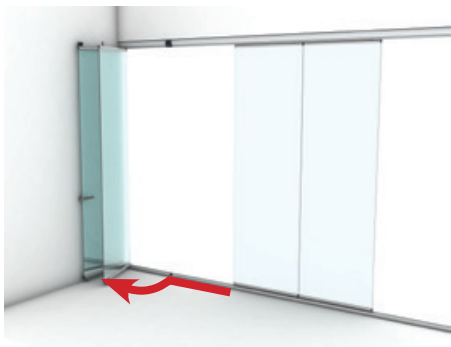

11



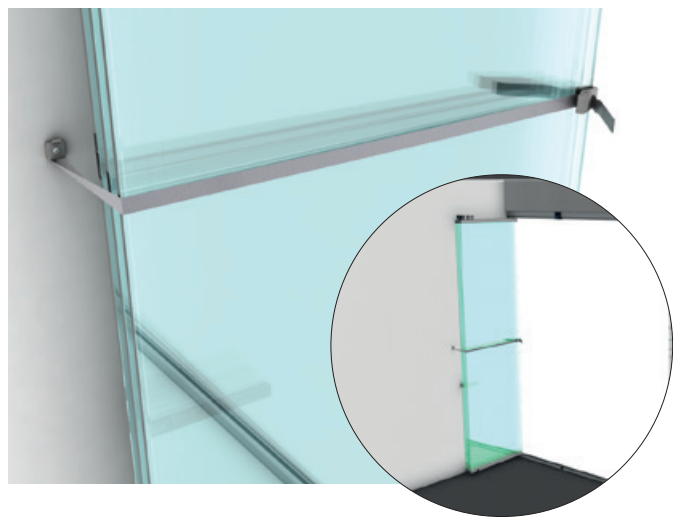
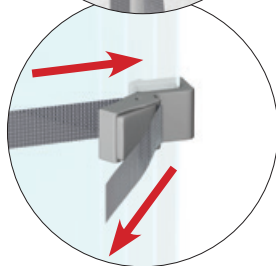

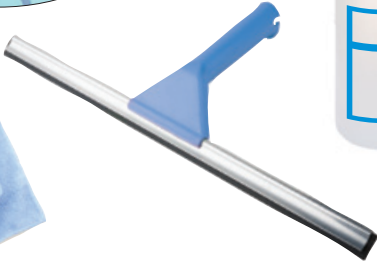

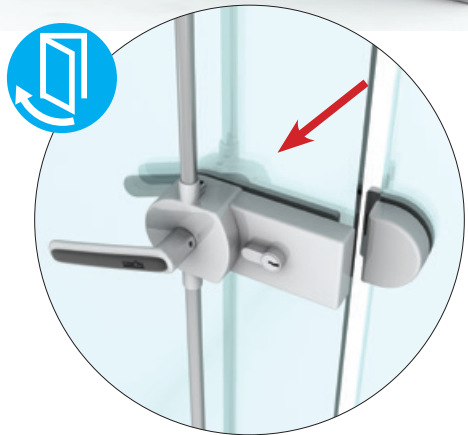
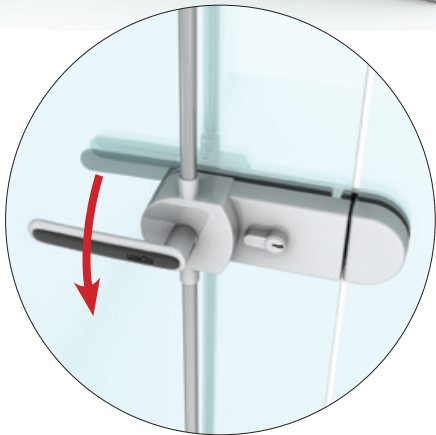

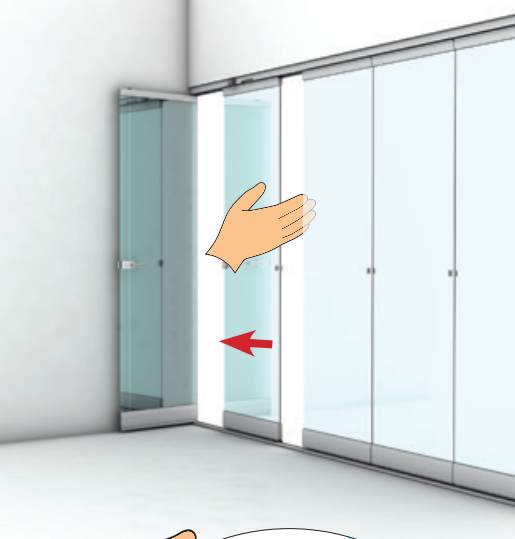

3

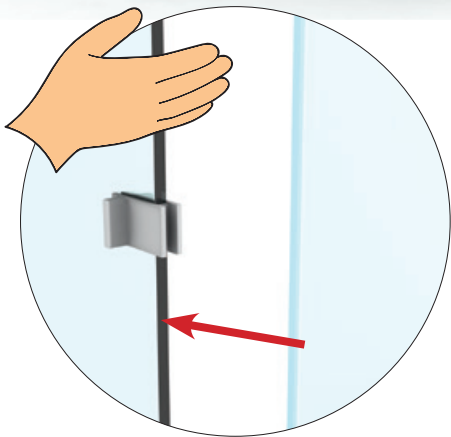

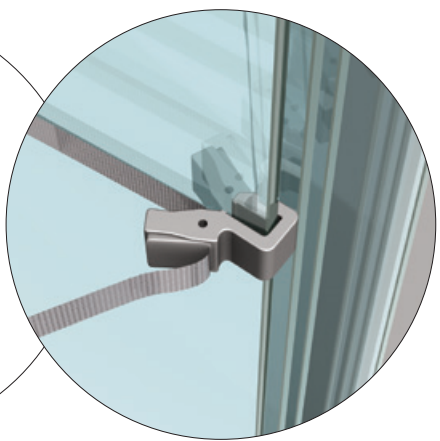
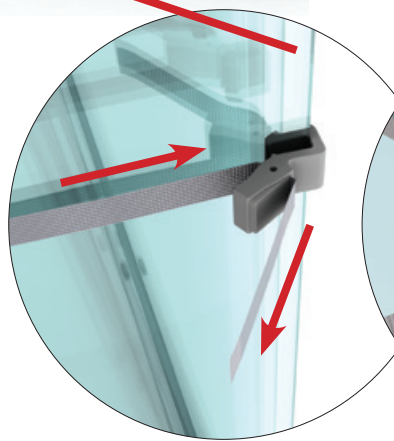
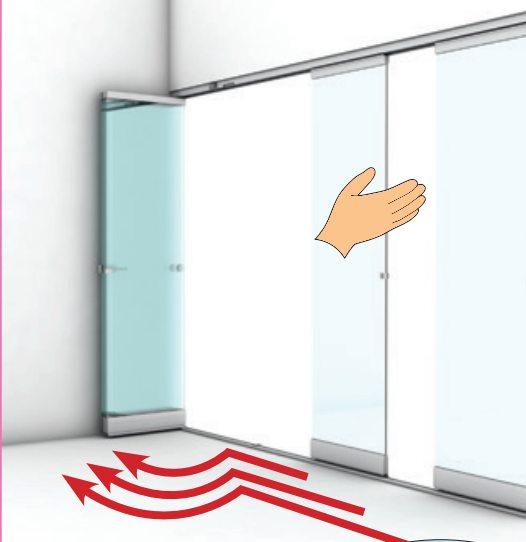



3

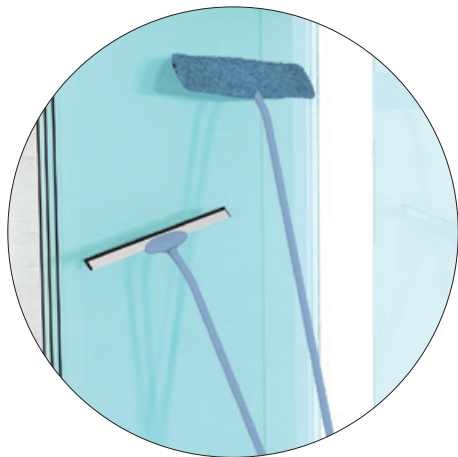

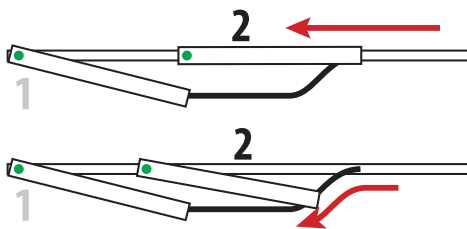
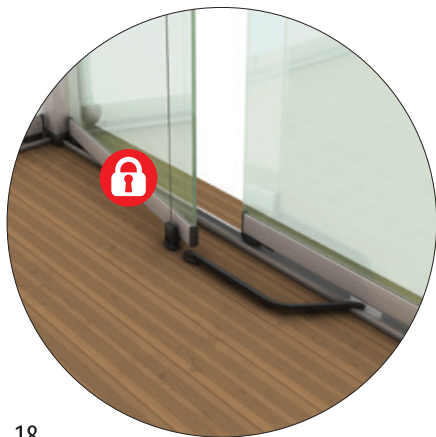
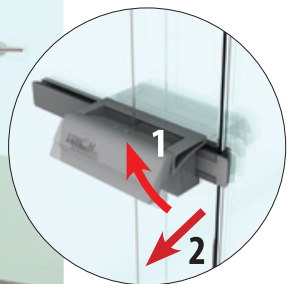
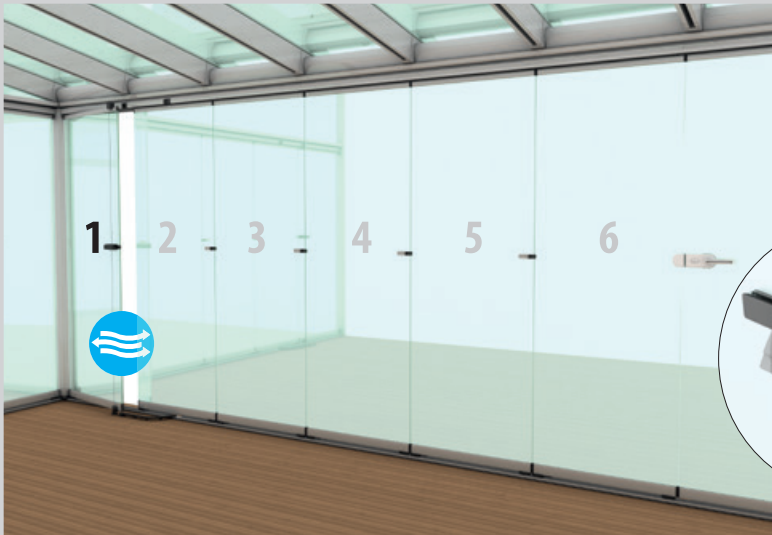

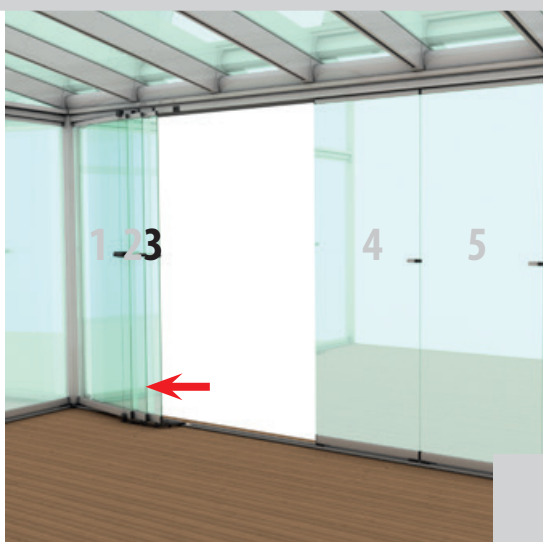
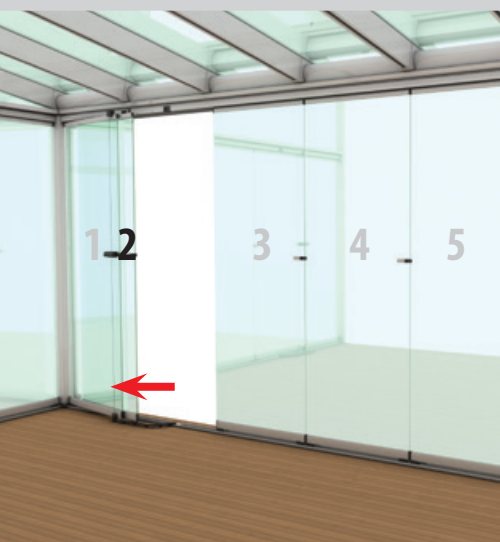

4

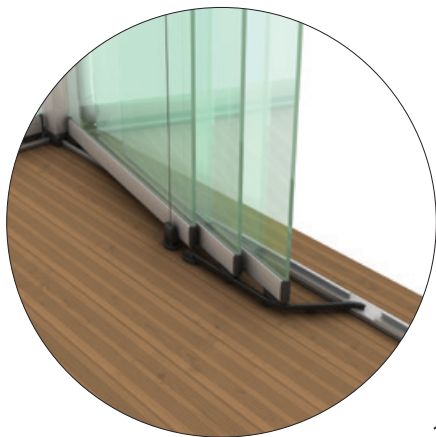
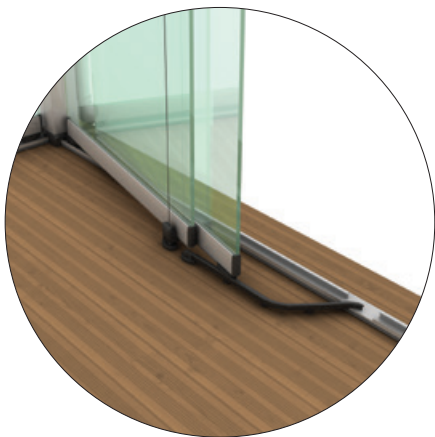

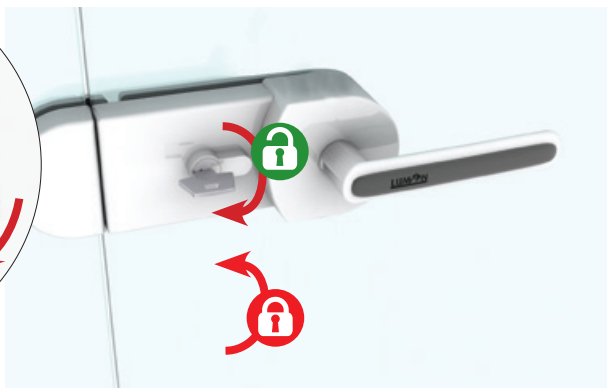
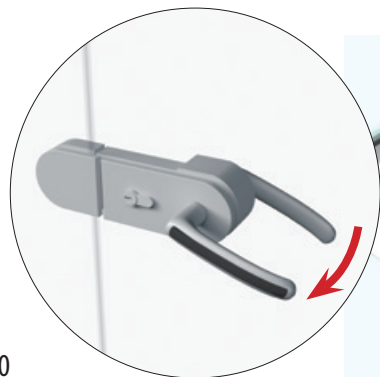
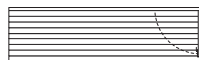

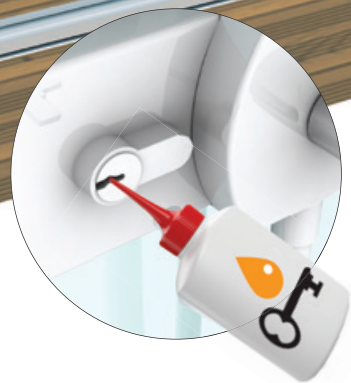

4





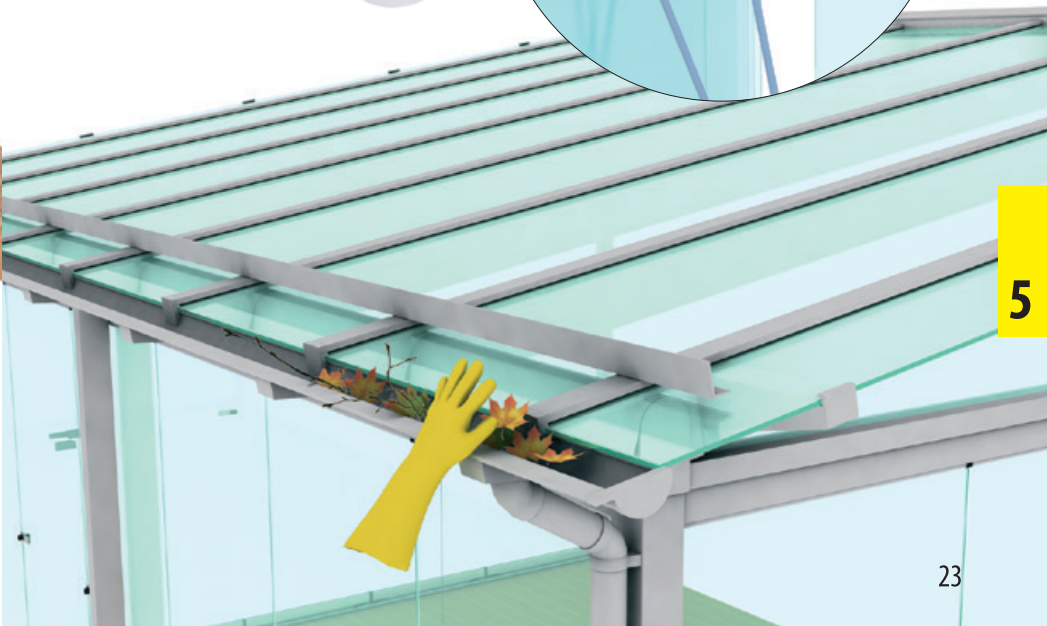
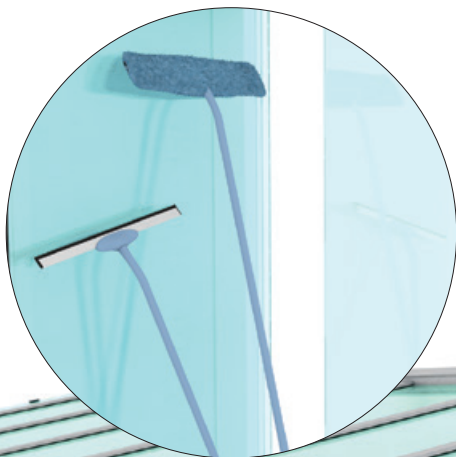

5

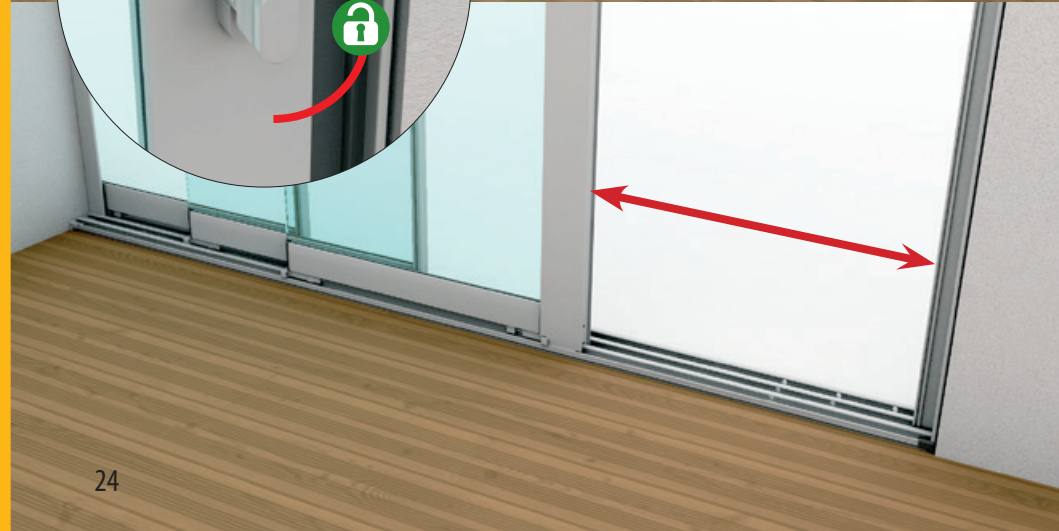



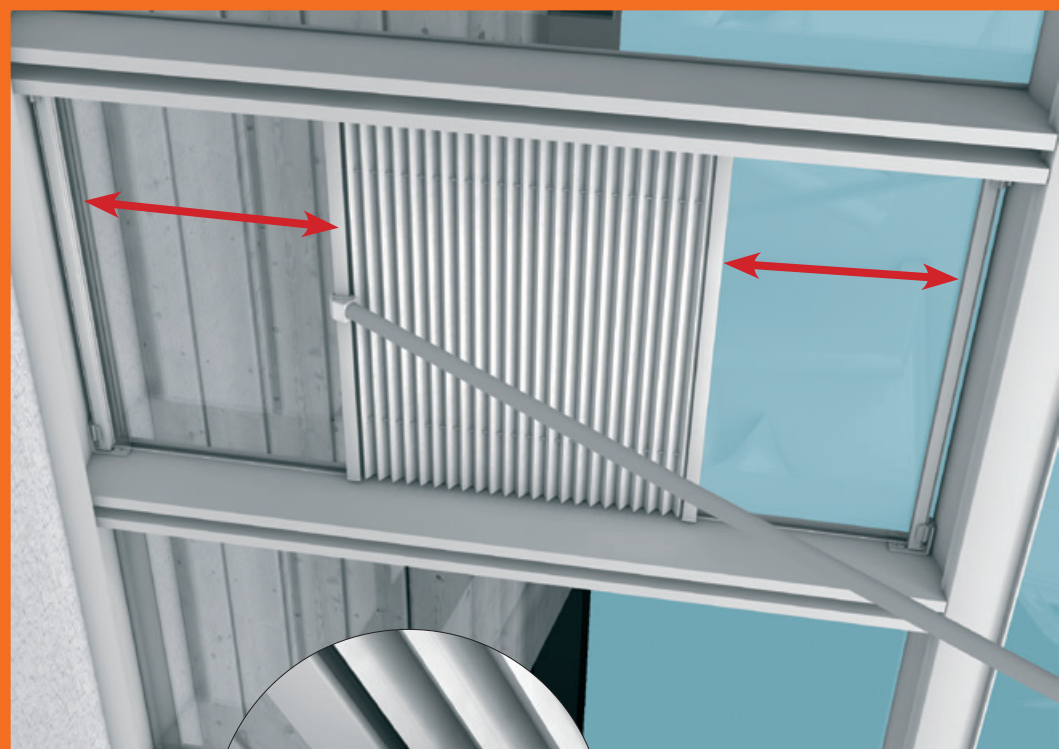

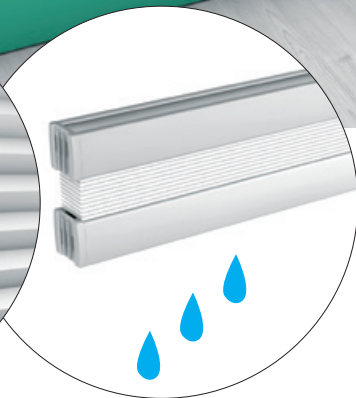
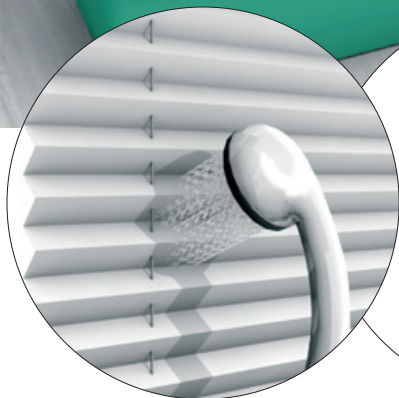
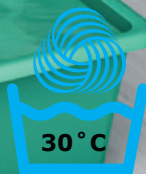
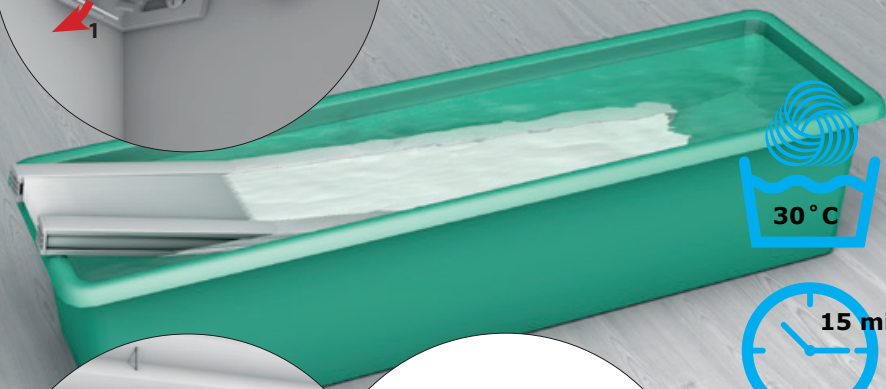
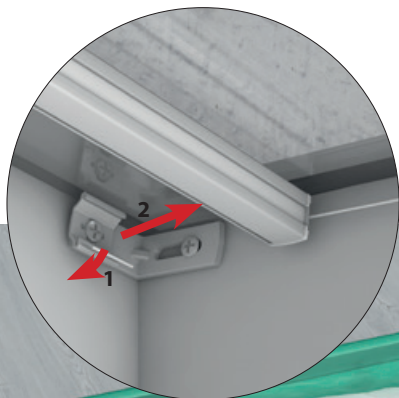

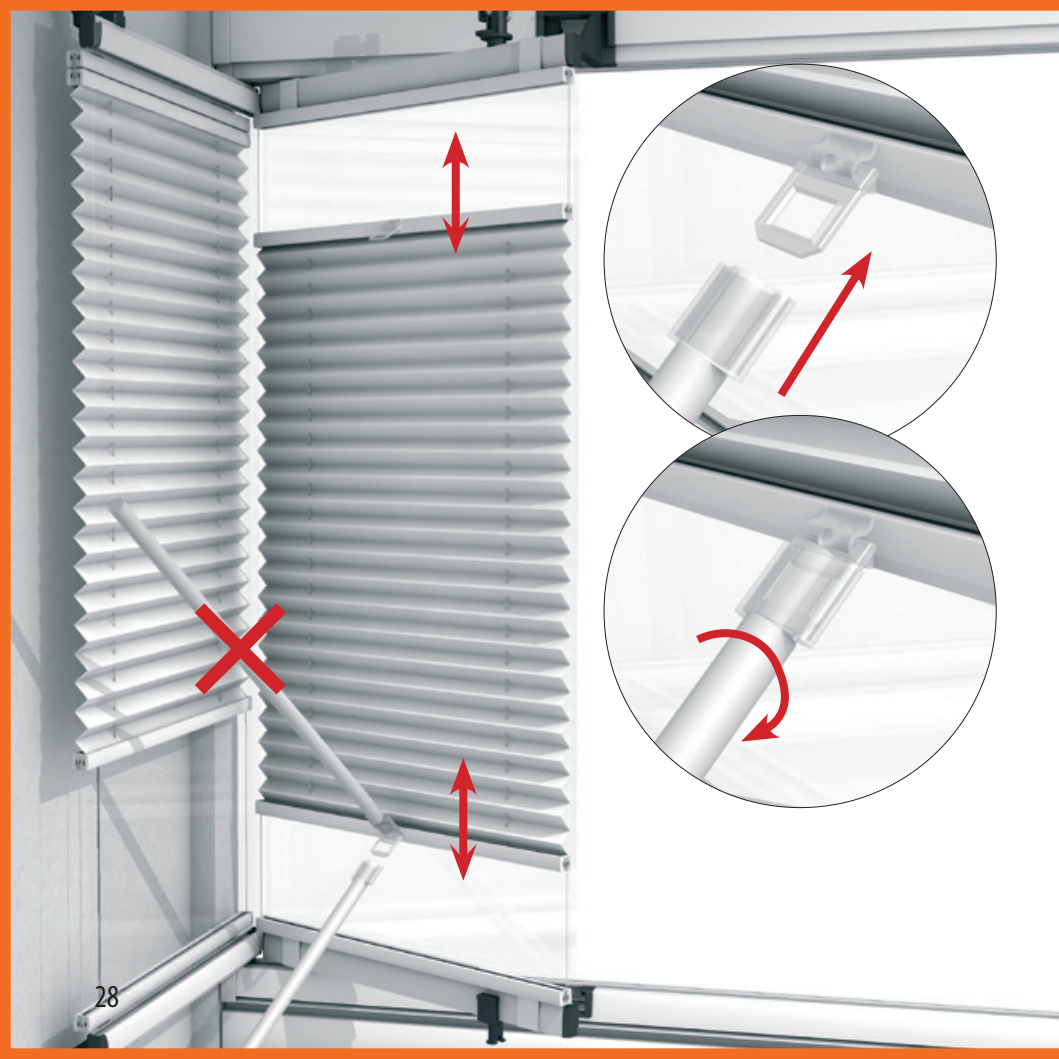

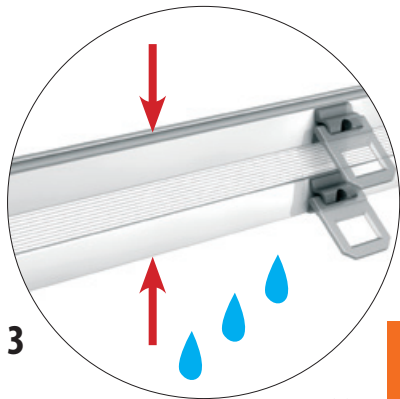
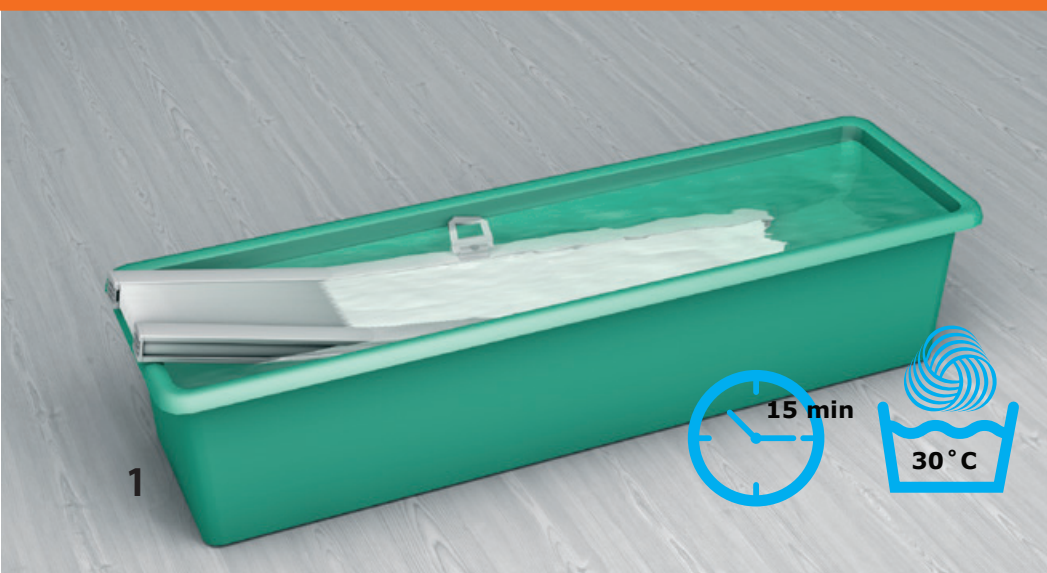

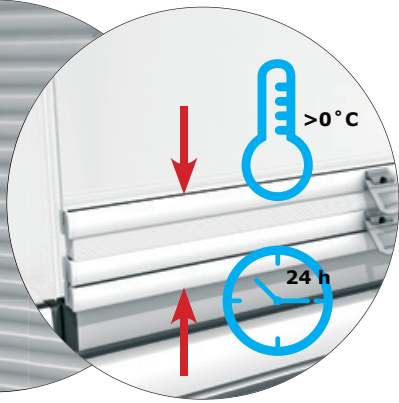
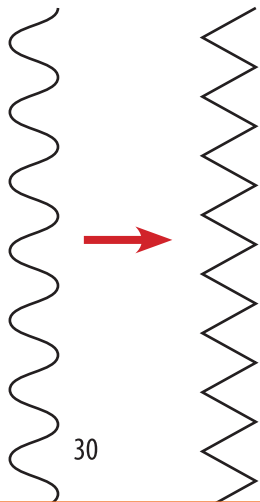

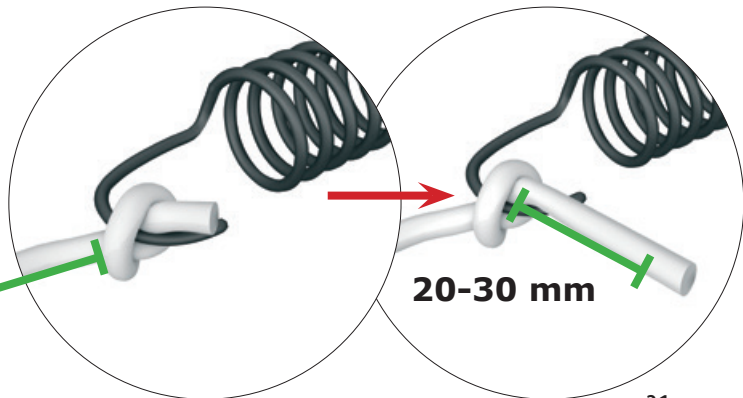
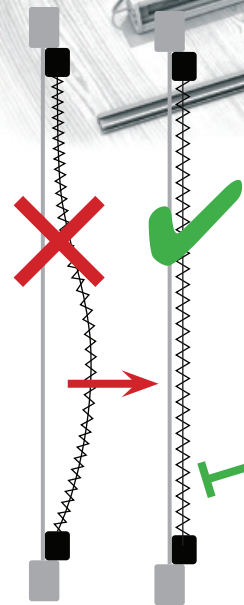

20-30 mm

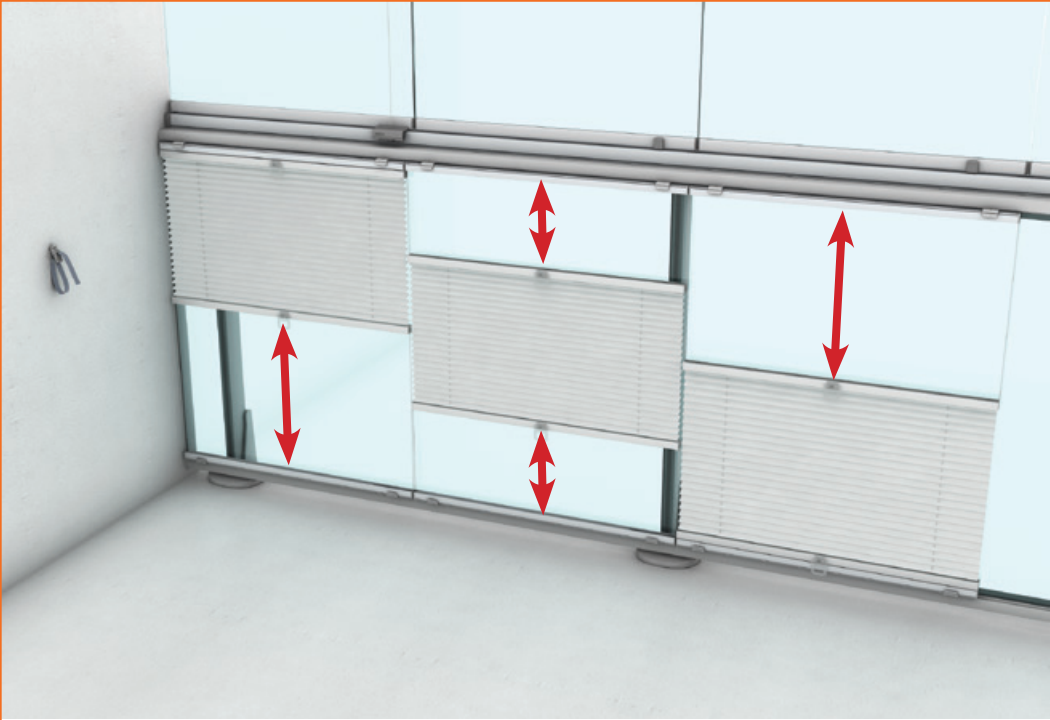

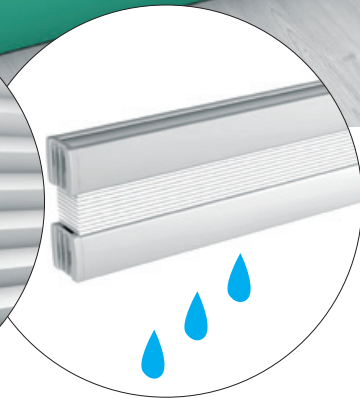
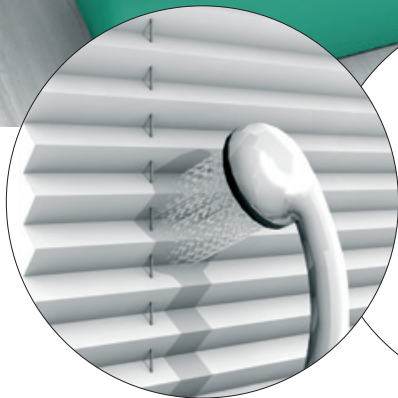
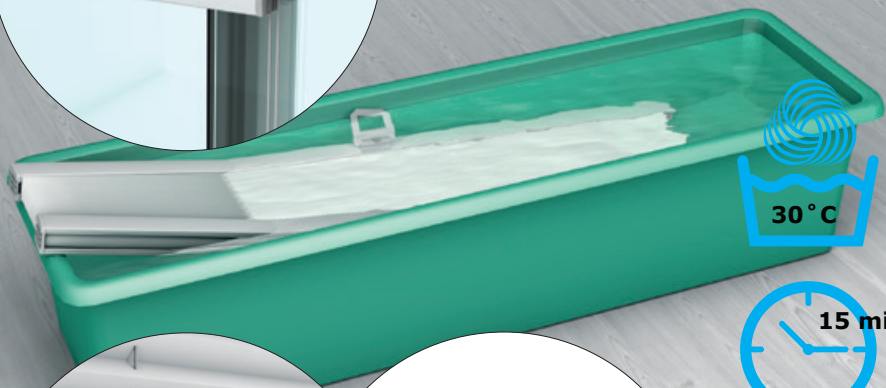
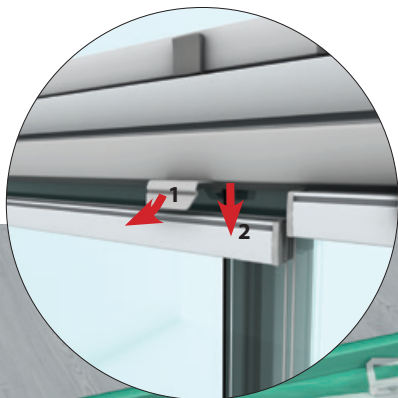



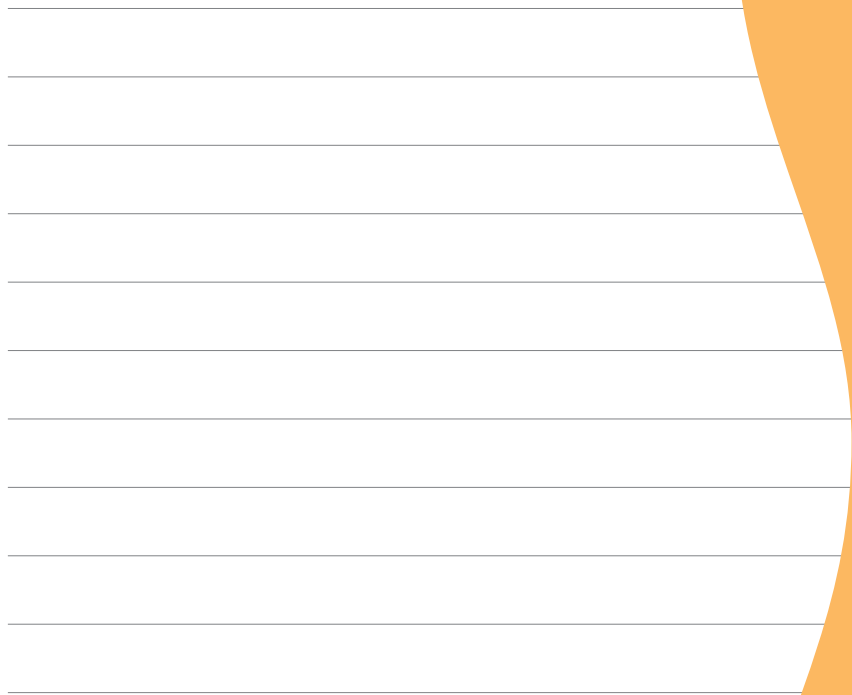

A page with a white background and a large orange shape on the right side. The white area contains 13 horizontal lines for writing.

Valmistaja / Tillverkare / Produsent / Producent / Framleiðandi /
Producer / Fabricante / Producent / Fabricante / Fabriqué par /
Производитель

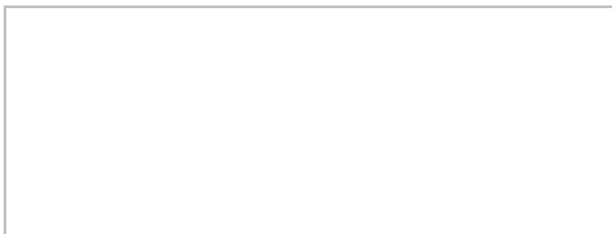

www.lumon.com

Lumon Oy, Kaitilankatu 11, FIN-45130 Kouvola, Finland,
info@lumon.com
tel +358 20 7403 200, fax +358 20 7403 393